

**Note-**  
 1. BUILDING HAS AUTOMATIC SPRINKLER SYSTEM WHEREVER REQUIRED BY NBC.  
 2. BUILDING WILL BE DESIGNED FOR RESISTANCE AS PER ELEMENT IS CODES FOR CARBONARIE RESISTANCE.

This is a PROVISIONAL BUILDING PLAN for the purpose of obtaining the necessary approvals from the project authority. It is subject to change without any notice.

**APPHO**  
 Architect  
 Consultant

**APPHO**  
 Member  
 Building

**APPHO**  
 Member  
 Building

**PROJECT:**  
 ADDITION & REVISED BUILDING PLAN OF BASEMENT 2 & 3 OF GROUP HOUSING COLONY MEASURING 24.10 ACRES (LICENSE NO. 80 OF 2012 DATED 17/09/2012) IN SECTOR 106, GURUGRAM MANESAR URBAN COMPLEX BEING DEVELOPED BY ARMD DEVELOPERS LTD. & OTHERS.

**OWNER'S SEAL & SIGNATURE:**  
 For Elm Avenue Ltd.  
 Authorized Signatory

**ARCHITECT'S SEAL & SIGNATURE:**  
 Architect

**Scale:** 1:300

**Drawing No.:** PHASE I  
 BASEMENT-2-AREA CHART

**Drawing No.:** BA-04

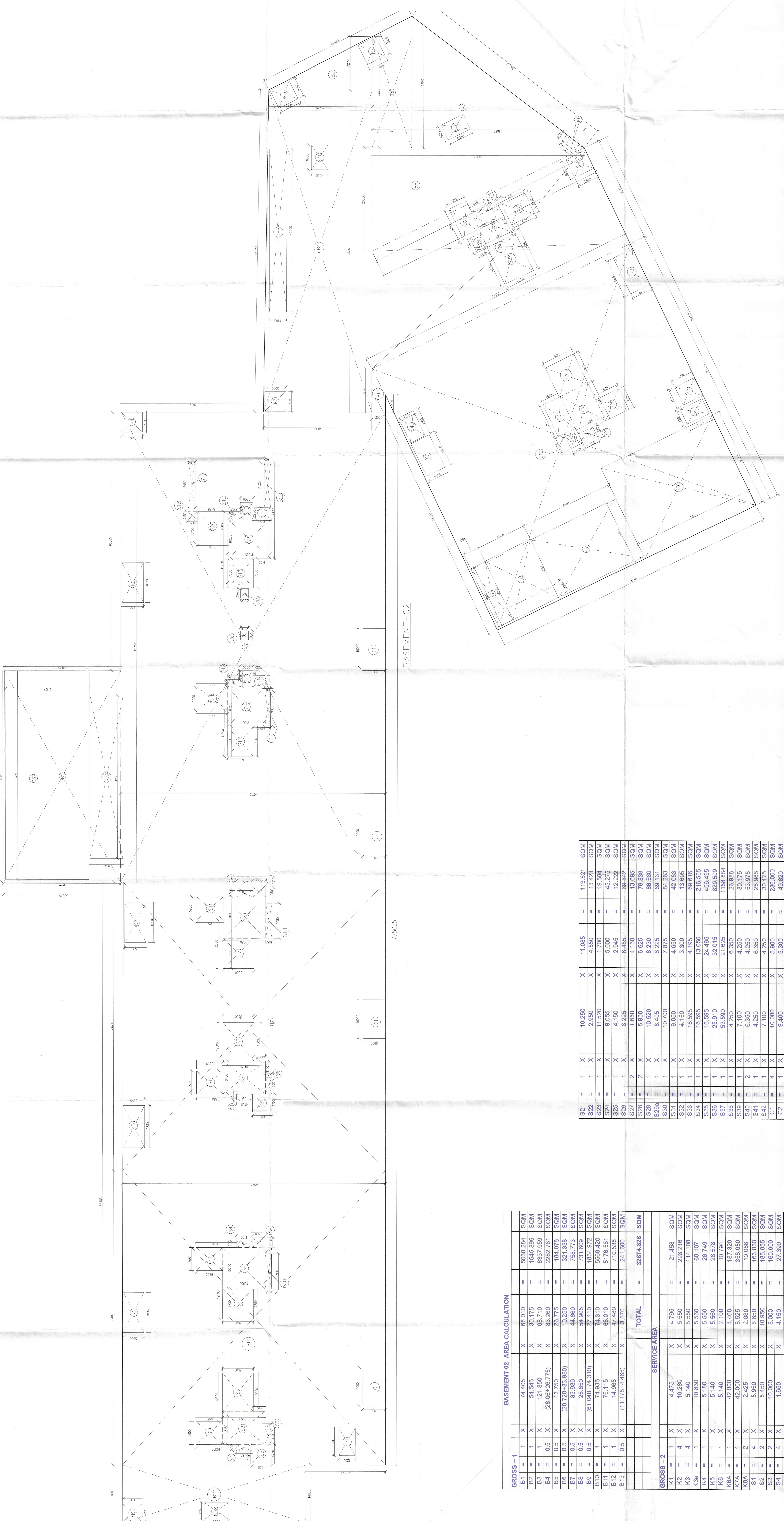

BASEMENT-02 AREA CALCULATION			
<b>GROSS - 1</b>			
B1	= 1 X	74.405	X 88.010 = 5060.284 SQM
B2	= 1 X	54.545	X 30.175 = 1645.895 SQM
B3	= 1 X	121.350	X 68.710 = 8337.959 SQM
B4	= 0.5 X	(28.08*26.775)	X 69.260 = 2292.781 SQM
B5	= 0.5 X	(13.75*10.880)	X 26.775 = 184.078 SQM
B6	= 0.5 X	(28.73*10.880)	X 26.775 = 753.973 SQM
B7	= 0.5 X	33.650	X 44.660 = 731.608 SQM
B8	= 0.5 X	26.650	X 54.905 = 1463.072 SQM
B9	= 0.5 X	(61.040*74.310)	X 27.410 = 1854.972 SQM
B10	= 1 X	74.935	X 74.310 = 5568.420 SQM
B11	= 1 X	76.115	X 88.010 = 5176.581 SQM
B12	= 1 X	14.965	X 47.480 = 710.538 SQM
B13	= 0.5 X	(11.775*4.465)	X 8.570 = 241.600 SQM
<b>TOTAL</b>			<b>= 32874.828 SQM</b>
<b>GROSS - 2</b>			
K1	= 1 X	4.475	X 4.795 = 21.458 SQM
K2	= 4 X	10.260	X 5.550 = 228.216 SQM
K3	= 4 X	5.140	X 5.550 = 114.108 SQM
K3a	= 1 X	10.830	X 5.550 = 60.107 SQM
K4	= 1 X	5.180	X 5.550 = 28.749 SQM
K5	= 1 X	5.140	X 5.550 = 28.578 SQM
K6	= 1 X	5.140	X 2.100 = 10.794 SQM
K6A	= 1 X	42.000	X 4.460 = 187.320 SQM
K7A	= 1 X	42.000	X 8.525 = 358.050 SQM
K8A	= 2 X	2.425	X 2.080 = 10.088 SQM
K9A	= 1 X	8.950	X 1.650 = 14.768 SQM
S1	= 1 X	10.000	X 8.000 = 80.000 SQM
S4	= 2 X	1.650	X 4.150 = 13.845 SQM
S5	= 2 X	4.300	X 4.950 = 42.870 SQM
S6	= 2 X	14.190	X 1.850 = 131.613 SQM
S7	= 2 X	7.750	X 8.000 = 124.000 SQM
S8	= 2 X	10.700	X 10.950 = 237.435 SQM
S9	= 2 X	2.500	X 3.300 = 16.500 SQM
S10	= 2 X	6.950	X 1.650 = 23.865 SQM
S11	= 1 X	5.950	X 7.900 = 47.005 SQM
S12	= 2 X	1.950	X 3.235 = 12.617 SQM
S13	= 1 X	10.950	X 9.985 = 109.262 SQM
S14	= 1 X	10.950	X 3.300 = 36.135 SQM
S15	= 2 X	2.950	X 3.950 = 23.598 SQM
S16	= 1 X	2.950	X 3.950 = 11.753 SQM
S17	= 1 X	9.050	X 1.500 = 13.575 SQM
S18	= 1 X	2.150	X 2.435 = 5.235 SQM
S19	= 1 X	13.950	X 1.900 = 26.505 SQM
S20	= 1 X	7.900	X 7.900 = 62.410 SQM
<b>TOTAL</b>			<b>= 32874.828 SQM</b>
<b>NET AREA OF BASEMENT - 02</b>			<b>= 32874.828 SQM</b>
<b>NO OF ECS ACHIEVABLE OF BASEMENT -02</b>			<b>= 26625.015</b>
<b>PROPOSED CAR PARKING</b>			<b>= 832 ECS</b>